

## ETHERNET

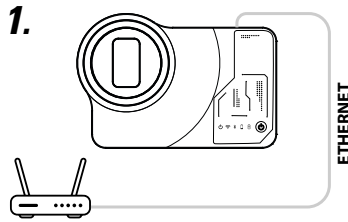

**1.** Collegare la macchina al router tramite il cavo, accenderla ed attendere la luce verde.  
Connect the machine to the router with the cable, turn it on and wait for the green light.

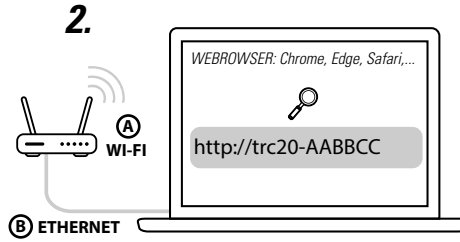

**2.** Digitare l'hostname presente sull'etichetta sotto la TRC20 nel browser  
Enter the hostname (TRC20 bottom label) in the browser

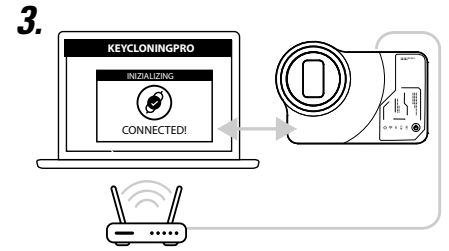

**3.** La macchina è quindi connessa  
It is already connected via ETHERNET cable

## WIFI

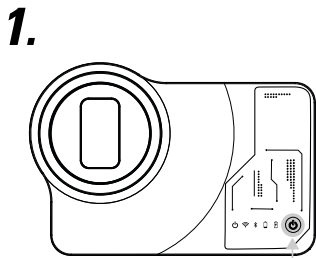

**1.** Accendere la macchina ed attendere la luce verde  
Turn on the machine and wait for the green light

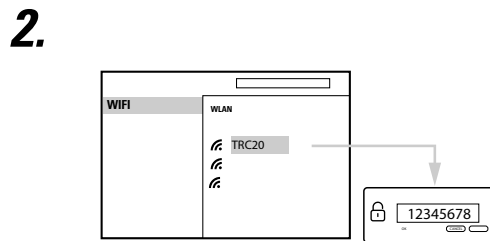

**2.** Cercare "TRC20" nelle reti Wifi ed inserire la password 12345678  
Search for the TRC20 WiFi network and enter the password 12345678

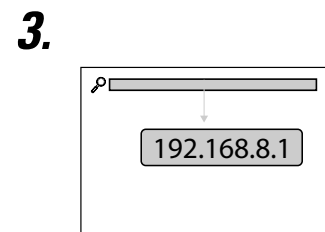

**3.** Nel browser, digitare l'indirizzo IP 192.168.8.1  
Enter the IP address in the browser: 192.168.8.1

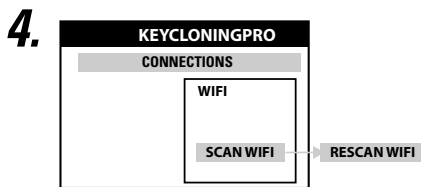

**4.** KeycloningPro - Connessioni - Wifi - Scan Wifi - Rescan Wifi  
KeycloningPro- Connections- WIFI-Scan WIFI - Rescan WIFI

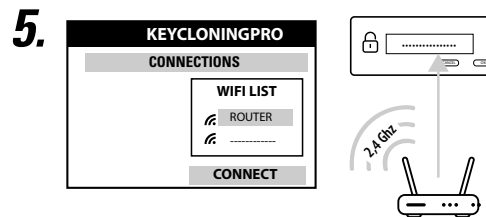

**5.** Selezionare la rete del router, inserire la relativa password e cliccare CONNECT  
Wi-Fi list- Select router network (make sure it's correct)- Enter password (assurez-vous que c'est correct)- CONNECT

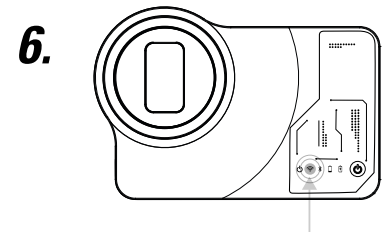

**6.** Quando sulla macchina il led del wifi sarà fisso\* ed il led dello stato passerà da rosso a verde, la macchina sarà pronta  
The machine will be ready when the white led of the Wifi changes to fixed\* and the Status LED changes from red to green.

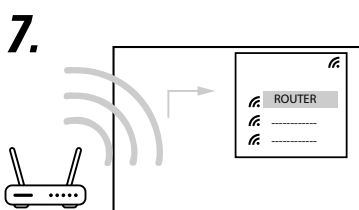

**7.** Selezionare sul PC la stessa rete del passo 5  
Select the same network from step 5 in the display device

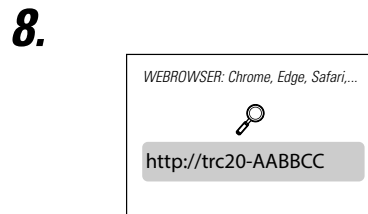

**8.** Digitare l'hostname presente sull'etichetta sotto la TRC20 nel browser  
Enter the hostname (Evexpert bottom label) in the browser

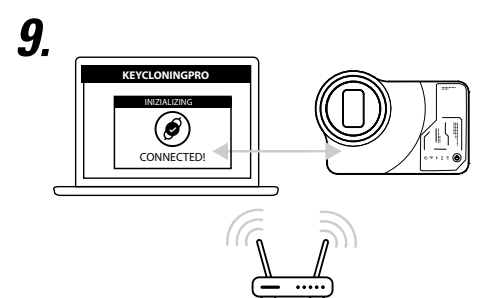

**9.** La macchina è quindi connessa  
The machine is connected through WIFI

\* \*Se il led non diventa fisso, riprendere dal passo 2 \* If the white LED does not change to a fixed state, go back to step No. 2

NOTA / NOTE  
A condizione che sul TRC20 sia stata precedentemente configurata una rete Wi-Fi, sarebbe necessario ripristinare le impostazioni di fabbrica. Per fare ciò, premere per 1 secondo il pulsante di ripristino situato sul retro del TRC20.  
Provided that a WiFi network has been previously configured in the TRC20, it would be necessary to return to the factory default settings. To do this, press the reset button located on the back of the TRC20 for 1 second.

# TRC20

## MODALITÀ DI CONFIGURAZIONE INIZIALE. DISPOSITIVO MOBILE INITIAL SETUP MODES. MOBILE DEVICE

### WIFI

1.

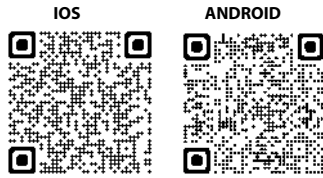

Scarica e installa l'APP  
Download and install the APP

2.

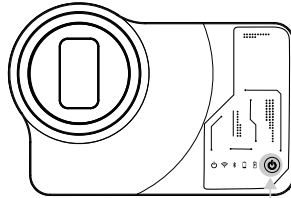

Accendere la macchina e attendere la luce verde  
Turn on the machine and wait for the green light

3.

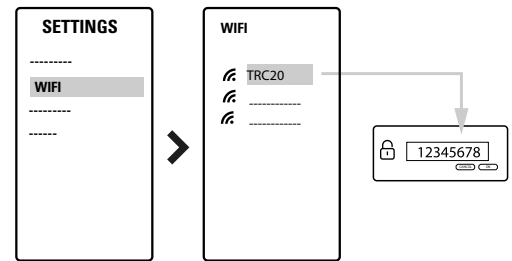

Cerca la rete WiFi TRC20 e inserisci la password 12345678  
Search for the TRC20 WiFi network and enter the password 12345678

4.

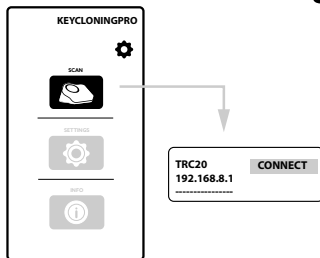

Apri APP, seleziona SCANSIONE e premi Connetti su TRC20  
Open the APP, select SCAN and press connect on TRC20

5.

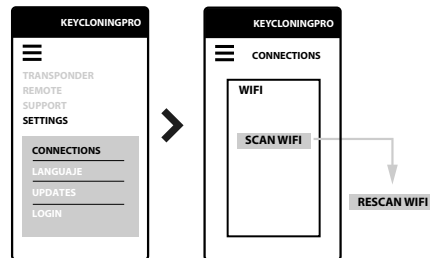

KeyCloningPro- Connessioni- WIFI- Scan WIFI - Rescan WIFI  
KeyCloningPro- Connections- WIFI- Scan WIFI - Rescan WIFI

6.

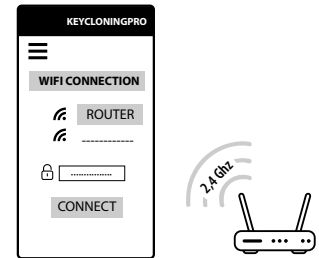

Lista WI-FI- Seleziona la rete del router- Inserisci la password (Assicurati che sia corretta)- CONNETTI  
WI-FI list- Select router network - Enter password (make sure it's correct)- CONNECT

7.

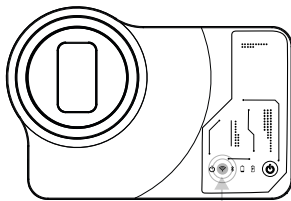

La macchina sarà pronta quando il led bianco del Wi-Fi diventa fisso\* e il LED di stato passa da rosso a verde.  
The machine will be ready when the white led of the Wifi changes to fixed\* and the Status LED changes from red to green.

8.

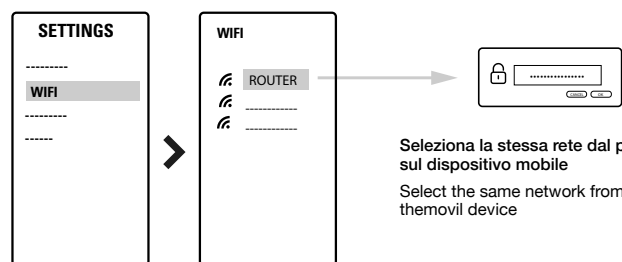

Seleziona la stessa rete dal passaggio 6 sul dispositivo mobile  
Select the same network from step 6 in the mobile device

9.

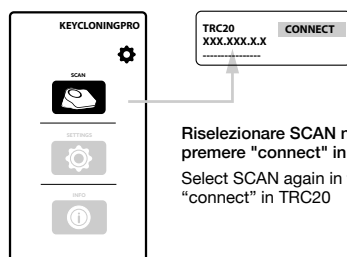

Riselezionare SCAN nell'APP e premere "connect" in TRC20  
Select SCAN again in the APP and press "connect" in TRC20

10.

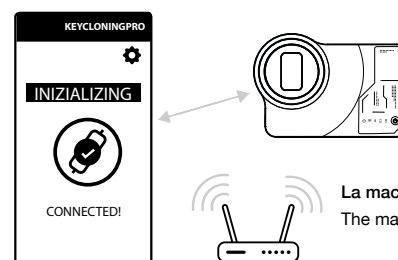

La macchina è collegata tramite WIFI  
The machine is connected through WIFI

\* Se il LED bianco non passa allo stato fisso, tornare al punto 2 \* If the white LED does not change to a fixed state, go back to step No. 2

#### NOTA / NOTE

A condizione che sul TRC20 sia stata precedentemente configurata una rete Wi-Fi, sarebbe necessario ripristinare le impostazioni di fabbrica. Per fare ciò, premere per 1 secondo il pulsante di ripristino situato sul retro del TRC20.  
Provided that a WiFi network has been previously configured in the TRC20, it would be necessary to return to the factory default settings. To do this, press the reset button located on the back of the TRC20 for 1 second.